

# MEDTraceNX®

## USE AND CARE GUIDE

**VAPORIZER+STERILIZER Model: STX021**

**INPUT: 220-240V 50Hz ~1.2A**

*Unique Steamer Inhaler that helps in relief from cold and cough with additional all in one baby feeding bottle sterilizer and warmer features.*



**BPA Free**

Key parts are made using **FOOD GRADE** PP plastic material and meets IS-10910.



Dear Customer,

Welcome to the family of MEDTraceNX's Health Product users. Your new Personal Vaporizer+Sterilizer will provide you and your family with soothing steam vapor with additional features including Sterilization and Warmer capabilities. We hope our product will exceed your expectations in every way. However, should you experience any problems, please reach to our email [info@MEDTraceNX.com](mailto:info@MEDTraceNX.com) right away.

Sincerely,

MEDTraceNX Team

### FEATURES:-

- **COMPACT:** Portable Steam Vaporizer
- **STEAM SWIRL:-**Mixed warm steam (Patent Pending)
- **STERILIZER** compartment to sterilizing baby feeding bottle:  
Safe and effective sterilization for baby bottles, teethers, utensils and other baby items. Kills 99.9% of harmful bacteria and germs in 4-8 minutes! **Sterilization efficacy test certificate is available on our website.**
- **WARMER** to lukewarm the milk/water for babies.
- Made of BPA free and Food Grade plastic.

### CONDITION OF SALE

Important: As a condition of sale, the purchaser assumes responsibility for the proper care and use of this appliance in accordance with our printed instructions. The purchaser or user must judge for himself or herself when to use it and length of use.

# READ INSTRUCTIONS BEFORE USING



**CAUTION: ELECTRIC HAZARD! UNPLUG FROM ELECTRIC OUTLET WHILE FILLING WATER AND WHILE MOVING EQUIPMENT . DO NOT TOUCH INTERNAL PARTS AND WATER WHILE OPERATING. CLOSE SUPERVISION IS NECESSARY WHEN THIS PRODUCT IS USED BY, ON OR NEAR CHILDREN OR INVALIDS.**



## How to Use

### 1. STEAM GENERATION-

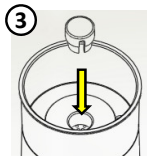
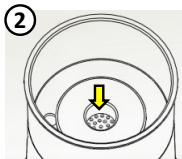

1. Unravel cord completely before use. Place Steam Inhaler on a flat, sturdy surface. **Do not plug to Electric Outlet.**

① 2. Fill water reservoir with ordinary tap water as per marked level. **DO NOT OVERFILL.** This will give you steam for approximately 15 -20 minutes.

② 3. Prescribed medical/ayurvedic medicines can be placed using cotton inside the medical cup. Place cap per figure 3. ③

4. Plug unit into electrical outlet. Do not use extension cords.

5. Allow one to two minutes for unit to produce full steam.

### 2. STEAM INHALER: -

1. Refer Section 1 (Steam Generation)

2. When steam starts to flow, place nose and mouth over steamer to a comfortable level.

3. Electric Hazard: Do not touch any wet surface and metal part of equipment.

4. Electrical heating appliance; close supervision is necessary when this product is used by, on or near children or invalids.

5. Now inhale the soothing steam vapor by breathing normally with nose and mouth for as many minutes as you desire and comfort.

6. If you suffer from any type of chronic skin disorder, consult your doctor or dermatologist before using this product.



# READ INSTRUCTIONS BEFORE USING

## How to Use



### 3. **STERILIZER:** - ALWAYS CLEAN EQUIPMENT WITH HOT WATER IF USED FOR INHALER BEFORE STERILIZATION.

Refer section 1 to fill water. To use this appliance as sterilizer, unplug power from electric outlet. Add items to sterilize and close with sterilizer cap. Plug unit to electrical outlet. Sterilize to four to eight minutes. Unplug power from electric outlet. Sterilizer parts are hot due to steam. Wait for 10-20 minutes before removing parts from appliance. Always use heat resistance dry gloves/cloth while touching hot surfaces.

4

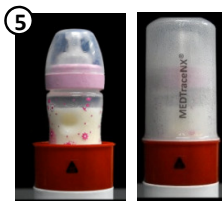

### 4. **WARMER:** - ALWAYS CLEAN EQUIPMENT WITH HOT WATER IF USED FOR INHALER BEFORE WARMER.

Refer section 1 to fill water. To use this appliance as warmer, unplug power from electric outlet. Add bottle filled with milk/formula to warm and close with sterilizer cap. **Don't fill bottles more than 2/3 full to prevent boil-overs. Keep lids and caps loosely closed.** Plug unit to electrical outlet. Lukewarm milk/formula in two to six minutes. User decides warming time based on warmness needed. Steamer and sterilizer parts are hot due to steam. Wait for 5-10 minutes before removing bottle from appliance. Always use heat resistance dry gloves/cloth while touching hot surfaces.

5



## After-Use Cleaning and Storage

1. Always unplug your appliance from electric outlet when finished using.
2. Wait for 30 minutes until unit has completely cooled.
3. After unit is completely cooled, remove sterilizer cap. Wipe equipment with a soft cloth.

4. If the unit is used several times a week, pour 2 spoon of white vinegar into water reservoir and let sit for ten minutes. Then rinse with fresh, clean tap water to eliminate scale buildup. NEVER IMMERSER THIS UNIT IN WATER.
5. Store in a cool and dry place.

## Important Safeguards



### CAUTION-

When using this electrical appliance, especially when children are present, basic safety precautions should always be followed, including the following:

1. Always **unplug** electric power to this appliance while filling water.
2. Always **unplug** electric power to this appliance immediately after using.
3. Do not use this appliance while bathing.
4. Do not use damaged appliance.
5. Do not place or store appliance where it can fall or be pulled into tub or sink.
6. Do not place in or drop into water or other liquid.
7. Do not reach for an appliance that has fallen into water. Unplug immediately.
8. An appliance should not be left unattended when plugged in.
9. Do not use appliance in case of water leakage from appliance.
10. Close supervision is necessary when this appliance is used by, on, or near children or invalids. Device contains small metal part which can block the respiratory tract and lead to choking. Therefore, make sure that you always keep the vaporizer and the accessories out of the reach of babies and infants.
11. Use this appliance only for its intended use as described in this manual. Do not use attachments not recommended for product.
12. Never operate this appliance if it has a damaged cord or plug, if it is not working properly, or if it has been dropped, damaged, or dropped into water.
13. Keep the cord away from heated surfaces.
14. Never place the appliance on a soft surface such as a bed or couch. Always place on a level surface.
15. Never use while sleepy or drowsy.
16. **Unplug cord before filling water and placing/removing parts from vaporizer during use.** Fill water only till maximum (max) water level marked on appliance. **Do not overfill.**
17. Never hold this steamer close to your face/body parts in one position, as this may cause scalding.
18. Do not place face/body parts close to steam exit ports, as this may cause scalding.
19. Do not touch hot surface. Wear dry gloves.



## SERVICE – FUSE REPLACEMENT



The appliance is over-current protected with **2 amps** in-line fuse. **REPLACEMENT PROCEDURE:-** Be extra careful when replacing fuse. **UN-PLUG** power before touching any electrical wire/fuse holder. Remove bottom black cap and locate fuse holder. Open fuse holder (Refer Image 6) and take out the fuse (Refer Image 7). Look for the blown fuse inside the center window of the fuse body. It is normally discolored, cloudy, or has a piece of broken or melted metal inside. Make sure that the replacement fuse is identical (**2 amps**) to the one it is replacing.

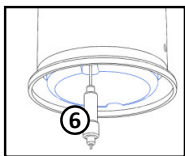

⑦



## WARRANTY

The appliance is warranted against defective material or workmanship for six months from date of purchase and nine months from the date of manufacture. **User/customer must send (email) scanned copy of sale details page to register for product warranty.** Should any defect develop, the unit should be securely wrapped and shipped postage paid to the address below. It will be promptly repaired/replaced and returned at no charge. Warranty does not cover damages resulting from misuse, abuse, tampering, accident, alterations for failure to use according to our printed directions. Manufacturer shall not be liable for any special or consequential damages for break of any written or implied warranty. **As a condition of sale, the purchaser assumes responsibility for the proper care and use of this appliance in accordance with our printed instructions.**

MODEL Number:- STX021 Color \_\_\_\_\_

Manufacturing Date :- Day[    ] Month[    ] Year[    ]

Quality Checked:- Wiring [    ]; Marking [    ]; Packaging [    ]

Manufacturer Seal:-

=====

Seller/Distributor (Signature and Seal):-

Date of Sale:- \_\_\_\_\_

Customer Name & Signature:- \_\_\_\_\_

**Important:** Customer must email scanned copy of this page to [info@MEDtraceNX.com](mailto:info@MEDtraceNX.com) for registering product warranty.

# MEDTraceNX®

**An ISO 13485 Certified &  
ZED Certified MSME**

**MEDTraceNX Health OPC Private Limited**

SP10, Ground Floor,  
NGEF Industrial Estate  
Mahadevpura, Bangalore  
Karnataka, India- 560048

Customer Care: [info@MEDTraceNX.com](mailto:info@MEDTraceNX.com)  
[www.MEDTraceNX.com/Steamer](http://www.MEDTraceNX.com/Steamer)